



ZLIN AIRCRAFT a.s.
Letiště 1578, 765 81 Otrokovice,
Czech Republic
e-mail: zlin-service@zlinaircraft.eu
<http://www.zlinaircraft.eu>

MANDATORY

**SERVICE
BULLETIN**

MANDATORY BULLETIN Z 242L/11a

Z 142C/ 7a

1. **AFFECTED AIRCRAFT :** Z 242L aircraft S/N 541, 651-659
Z 142C aircraft S/N 556-559
2. **SUBJECT :** At the extreme deflection of the nose-wheel steering the screw of the Spring-mechanism L 242.4217 may interfere with the nose-wheel strut body.
3. **CORRECTION :** Replace the cube Z 42.4217-00.03 by the cube L 242.4237-00.03 in the spring mechanism. Install the spring mechanism with its turnbuckle backwards.
4. **TIME OF COMPLIANCE:** At the next 100hour inspection.
5. **PERFORMED BY :** The Operator.
6. **EXPENSES COVERED BY:** Disassembly, reassembly and adjustment
- the Operator.
The material - the Manufacturer.
7. **PROCEDURE :**
 - a) Release the turnbuckle, remove the spring mechanism L 242.4217 (Item 1).
 - b) Remove the cube Z 42.4217-00.03 (Item 2).
 - c) Install the cube (Item 3) between the shaped sheets (use the screw M5x16-Item 5, the new cotter pin - Item 7 from the delivered material).
 - d) Re-install the spring mechanism L 242.4237 (Item 8) (for attachment to the control cable use the screw M5x18 (Item 4), the new cotter pin /Item 7/); for attachment to the nose landing gear strut use the original screw (Item 9), the new cotter pin (Item 6) from the delivered material). Tighten the cube (Item 3) with the screw (Item 9), so that the cube moves on the screw (Item 9).
 - e) Prestress the spring with the turnbuckle so that gaps between the spring coils 0,3-0,5 mm appear; then lock the turnbuckle with the binding wire. The rudder must be in the neutral position and the nose wheel parallel to the aircraft longitudinal axis during spring prestress adjustment.

- f) Check the nose wheel deflections and the control for easy movement.
- g) Replace old pages in the Z 142C Catalogue of Spare Parts by the new ones, enclosed to this Bulletin.

8. NECESSARY MATERIAL : (Enclosed to the Bulletin)

- Item 3 - Cube L 242.4237-00.03
(2 pcs on the aircraft)
- Item 6 - Cotter pin 1,6x16 ČSN 021781.04
(2 pcs on the aircraft)
- Item 7 - Cotter pin 1,2x14 ČSN 021781.04
(4 pcs on the aircraft).

9. THE BULLETIN COMES IN FORCE WITHIN 30 DAYS FROM THE DATE OF APPROVAL BY THE CAI OF THE CZECH REPUBLIC.

- 10. APPENDICES :**
- Fig.No.1 - the spring mechanism before modification
 - Fig.No.2 - the spring mechanism after modification
 - New pages of the Z 142C Spare Parts Catalogue:
4-37/4-38, 4-39/4-40, 4-41/4-42, 4-43.

Antonín Partika
.....
Manufacturer's
Representative

Milan Vyhnálek
.....
CAI Representative

17.5.1994
.....
Date of approval

CONTACT ADDRESS : **ZLIN AIRCRAFT a.s.**
ZLIN SERVICE
765 81 OTROKOVICE
CZECH REPUBLIC

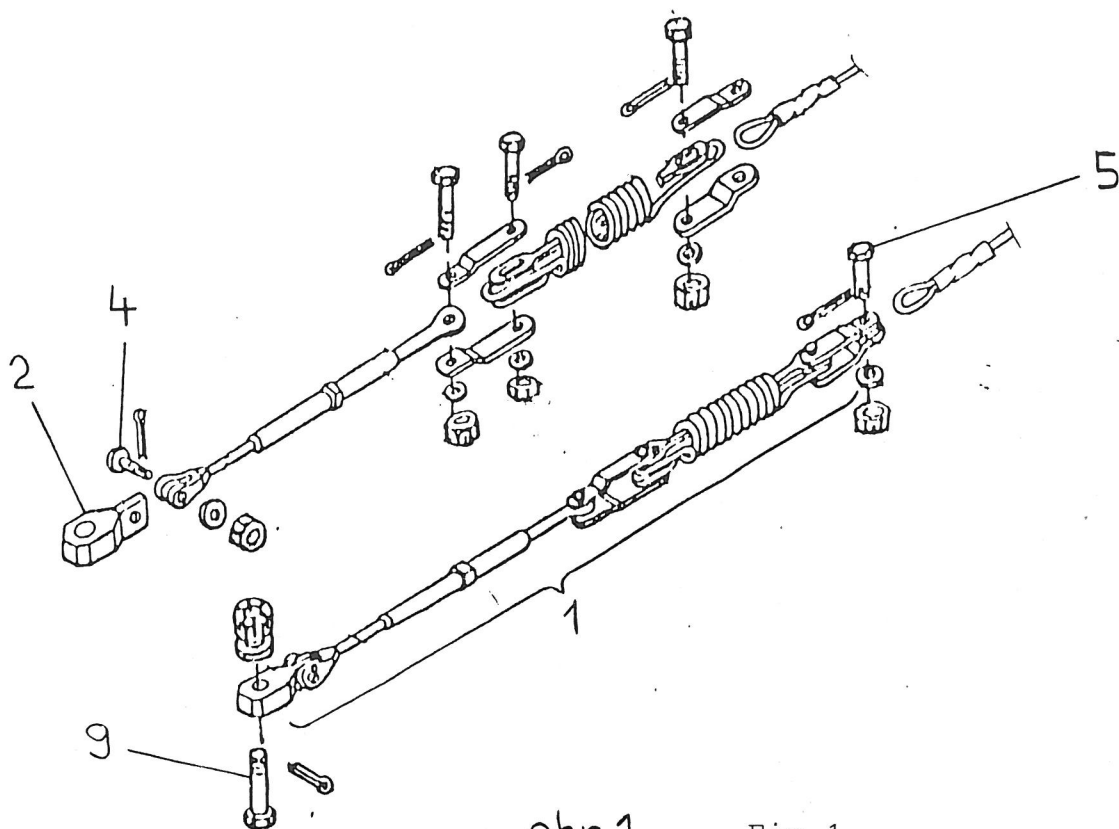

obr.1

Fig.1

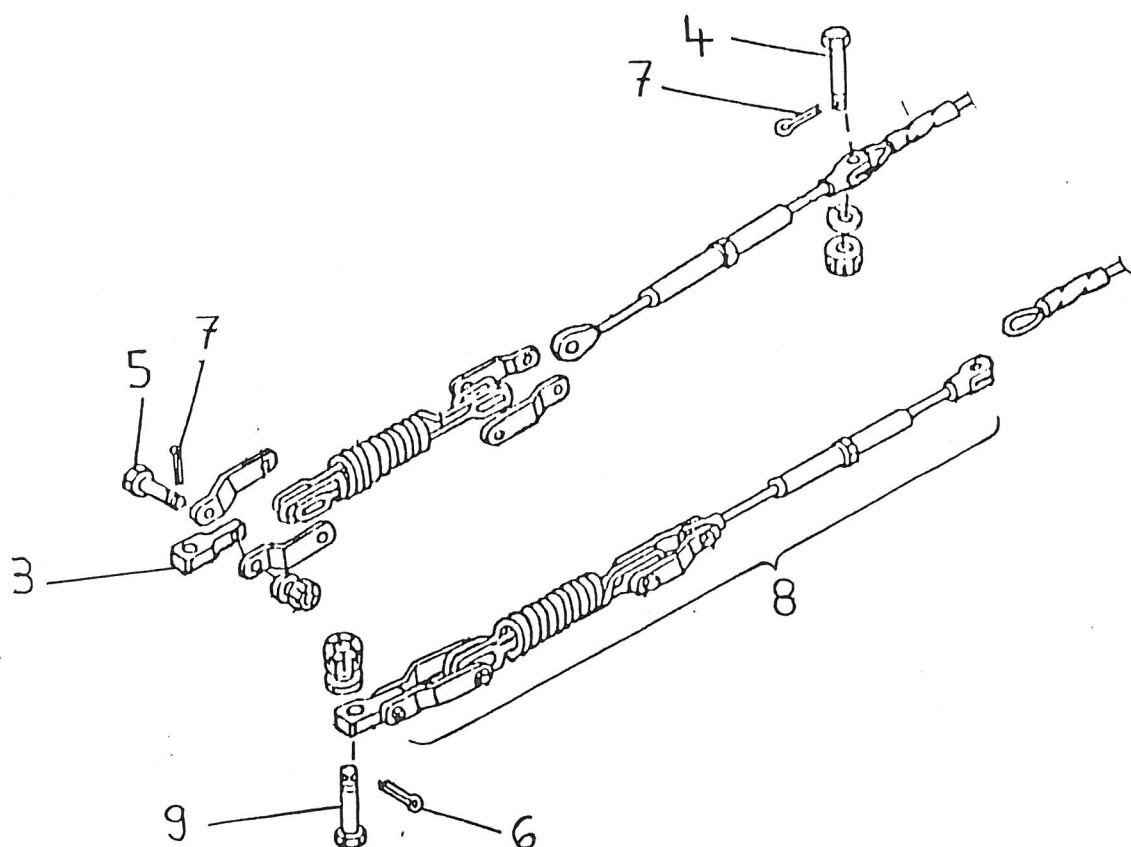

obr.2

Fig.2